

NEW PRODUCT!

Vertex™ Super-LED® Light (patent pending)

SINGLE, SELF-CONTAINED, HEMISPHERIC LIGHT



Officially Licensed Warning Lights Of NASCAR®



Actual Size!

Only 7/8" in height, this small semi-hemispheric LED lighthouse is perfect for most applications where size and intensity are critically important.

Self-contained unit using an in-line combination lamp driver/flasher.

FEATURES

- Ultra small, self contained, semi-hemispheric LED light, for surface mount or internal mount within composite head lamps, cornering lamps and tail light assemblies.
- 25 Scan-Lock™ flash patterns, includes synchronize feature for alternating and synchronous flashing of multiple lamps.
- New lens technology enhances light distribution for optimum dispersion and intensity of the warning signal at critical angles.
- Includes pre-wired and sealed 9' neoprene cable to the lighthouse and lamp driver, with 4-22 gauge power, pattern and synchronize pigtail wires.
- Aluminum base and advanced thermal heat management system is designed for endless years of trouble free service.
- Lamp and in-line lamp driver are fully encapsulated for moisture and vibration resistance.
- Omni-directional lighthouse mounts in any position (orientation), vertically or horizontally.
- Available in red, amber, white and blue. LED color must match color of the lens it is installed behind, except for clear lens
- 10 – 16 VDC.
- SAE Class 5.
- No RFI noise emitted.
- Two screws hold the lamp securely in place.
- 1" hole make this LED module backwards compatible to HA238 and standard 1" Hide-A-Way style lamps.
- Simple installation with no separate lamp drivers, flashers, ballast or power supplies to install.

Lamp Assembly

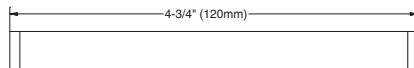
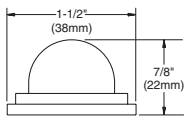

Lamp Driver

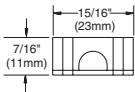

Available in Red, Amber White and Blue

Form# VTX0708

© 2008 Whelen Engineering Co., Inc. Printed in U.S.A. Whelen Engineering Inc. reserves the right to upgrade and improve products without notice. NASCAR® is a registered trademark of the National Association for Stock Car Auto Racing, Inc. Code No. 12187A/2-0708



All Whelen Products are proudly designed and manufactured in the U.S.A.

WHELEN®

ENGINEERING COMPANY, INC.

51 Winthrop Road
Chester, CT 06412-0684
(860) 526-9504 • Fax (860) 526-4078
www.whelen.com

Engineers for the Emergency Warning Industry

Vertex™ Super-LED® Light