

WHELEN[®]

ENGINEERING COMPANY INC.

Route 145, Winthrop Road,
Chester, Connecticut 06412

Phone: (860) 526-9504

Fax: (860) 526-4078

Internet: www.whelen.com

Sales e-mail: autosale@whelen.com

Canadian Sales e-mail: autocan@whelen.com

Customer Service e-mail: custserv@whelen.com

Installation Guide: Liberty™ and Freedom™ WeCan Lightbars

Safety First

This document provides all the necessary information to allow your Whelen product to be properly and safely installed. Before beginning the installation and/or operation of your new product, the installation technician and operator must read this manual completely. Important information is contained herein that could prevent serious injury or damage.

- Proper installation of this product requires the installer to have a good understanding of automotive electronics, systems and procedures.
- If mounting this product requires drilling holes, the installer **MUST** be sure that no vehicle components or other vital parts could be damaged by the drilling process. Check both sides of the mounting surface before drilling begins. Also de-burr any holes and remove any metal shards or remnants. Install grommets into all wire passage holes.
- If this manual states that this product may be mounted with suction cups, magnets, tape or Velcro™, clean the mounting surface with a 50/50 mix of isopropyl alcohol and water and dry thoroughly.
- Do not install this product or route any wires in the deployment area of your air bag. Equipment mounted or located in the air bag deployment area will damage or reduce the effectiveness of the air bag, or become a projectile that could cause serious personal injury or death. Refer to your vehicle owners manual for the air bag deployment area. The User/Installer assumes full responsibility to determine proper mounting location, based on providing ultimate safety to all passengers inside the vehicle.
- For this product to operate at optimum efficiency, a good electrical connection to chassis ground must be made. The recommended procedure requires the product ground wire to be connected directly to the **NEGATIVE (-)** battery post.
- If this product uses a remote device to activate or control this product, make sure that this control is located in an area that allows both the vehicle and the control to be operated safely in any driving condition.
- Do not attempt to activate or control this device in a hazardous driving situation.
- This product contains either strobe light(s), halogen light(s), high-intensity LEDs or a combination of these lights. Do not stare directly into these lights. Momentary blindness and/or eye damage could result.
- Use only soap and water to clean the outer lens. Use of other chemicals could result in premature lens cracking (crazing) and discoloration. Lenses in this condition have significantly reduced effectiveness and should be replaced immediately. Inspect and operate this product regularly to confirm its proper operation and mounting condition. Do not use a pressure washer to clean this product.
- It is recommended that these instructions be stored in a safe place and referred to when performing maintenance and/or reinstallation of this product.
- **FAILURE TO FOLLOW THESE SAFETY PRECAUTIONS AND INSTRUCTIONS COULD RESULT IN DAMAGE TO THE PRODUCT OR VEHICLE AND/OR SERIOUS INJURY TO YOU AND YOUR PASSENGERS!**

For warranty information regarding this product, visit www.whelen.com/warranty

Permanent Mounting:

1. Locate the mounting foot and mounting plate included with your lightbar. If not already present, install the mounting plate onto the mounting foot. When properly positioned, this plate is centered from side to side on the mounting foot.
2. Flip the lightbar upside-down to expose the bottom of the extrusion and place the mounting foot onto the extrusion.
3. Rotate the mounting foot 90° in a counter-clockwise direction. Make sure that the edges of the mounting foot swing into position under the extrusion mounting lip.
4. Repeat this procedure for the remaining mounting foot and return the lightbar to its right side-up position.
5. Position the lightbar onto the vehicle roof in the desired mounting location. One often selected location is directly above the B-pillars. This area is the strongest part of the roof. Refer to your lightbar manual for cable exit location, to be sure that the lightbar is facing the proper direction.
6. Adjust the two mounting feet outwards so that they are as close to the edge of the roof as possible. Make sure that both mounting feet are in full contact with the roof. Be sure that there is no less than 1/2" clearance between the roof and the lightbar at their closest point. When the mounting feet are in their proper position, lightly tighten the mounting foot allen head set screws.
7. Turn the lightbar upside down and firmly tighten all of the set screws from step 6 (2 or 4 per side).
8. On the mounting foot, remove either the two outer or inner rubber mounting pads. Carefully remove the mounting pad's guide dart so the hole through the center of the pad is exposed then replace the pad (Standard foot only). On the adjustable foot, use the hole in the pad as a guide to drill the two holes into the mounting foot.
9. Place the lightbar in its final mounting position on the vehicle, mark the mounting hole locations off onto the mounting surface, remove the lightbar and drill the mounting holes.

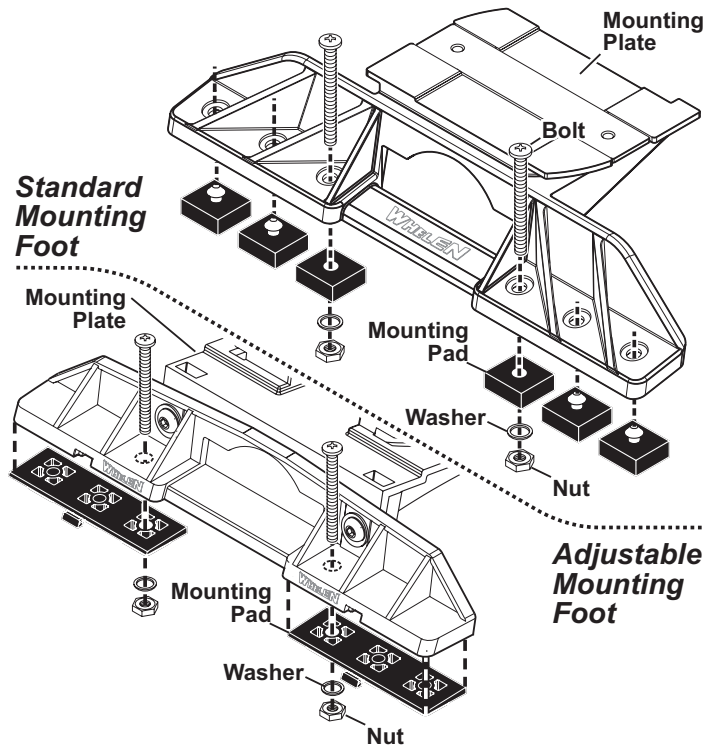

10. Place the lightbar back onto the vehicle lined up with the mounting holes and secure the mounting feet to the vehicle using the supplied hardware as shown.

Strap Mounting:

1. Locate the mounting foot, mounting plate and tinnerman plate included with your lightbar. If not already present, install the mounting plate onto the mounting foot. When properly positioned, this plate is centered from side to side on the mounting foot.

2. Flip the lightbar upside-down to expose the bottom of the extrusion and place the mounting foot onto the extrusion.
3. Rotate the mounting foot 90° in a counter-clockwise direction. Make sure that the edges of the mounting foot swing into position under the extrusion mounting lip. Install a tinnerman plate onto the extrusion in the same manner.

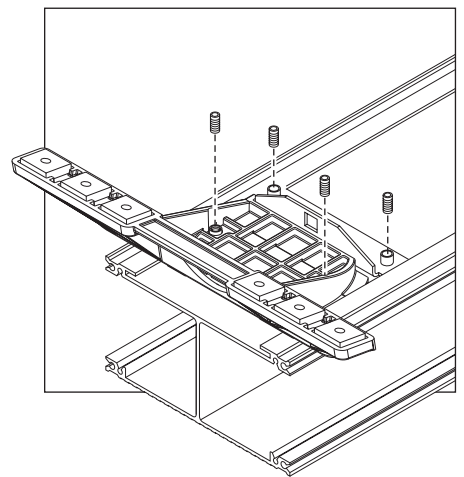
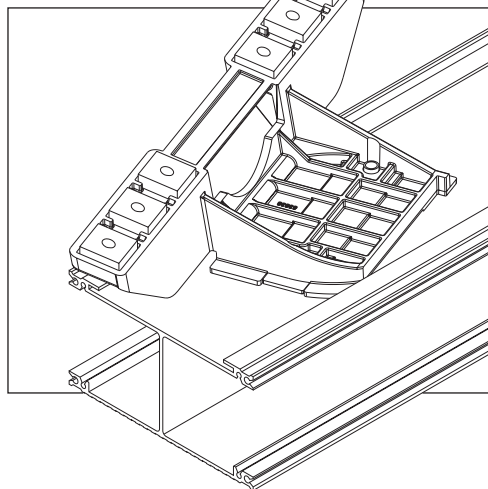
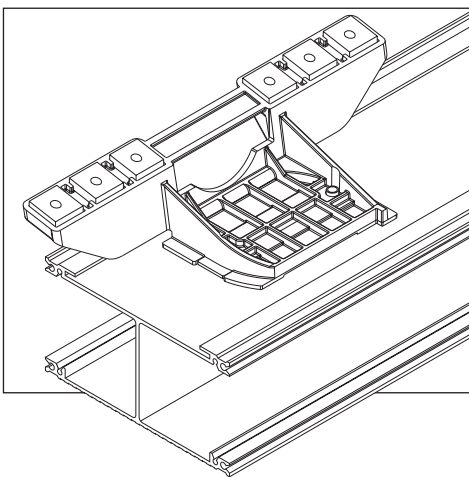

1. Repeat this procedure for the remaining mounting foot and tinnerman plate and return the lightbar to its right side-up position.
2. Position the lightbar onto the vehicle roof in the desired mounting location. One often selected location is directly above the B-pillars. This area is the strongest part of the roof. Refer to your lightbar manual for cable exit location, to be sure that the lightbar is facing the proper direction.
3. Adjust the two mounting feet outwards so that they are as close to the edge of the roof as possible. Both mounting feet must be in full contact with the roof. Be sure that there is no less than 1/2" clearance between the roof and the lightbar at their closest point. When the mounting feet are in their proper position, lightly tighten the mounting foot allen head set screws.
4. Return the lightbar to an upside down position. Slide each tinnerman plate outwards until it is fully engaged with its corresponding mounting foot. With the mounting feet and tinnerman plates in their proper positions firmly tighten all of the set screws (2 or 4 per side). Flip the lightbar right side-up and return it to its mounting position.
5. Open both drivers side doors. In the area directly below the mounting foot, carefully pull the drivers side weatherstrip away from the vehicle.

6. Insert the mounting strap through the mounting foot. Be sure that the strap fits flush against the area where it will be secured onto the vehicle. Insert the tension bolt through the mounting strap and into the tinnerman nut on the tinnerman plate. Tighten slightly with a long shafted, Phillips screwdriver. Repeat procedure for passenger side.
7. If your mounting strap has mounting holes in the end of the strap, use these holes as a template to drill appropriately sized pilot holes through the strap and into the vehicle. Repeat for passenger side of the vehicle.
8. Firmly tighten the tension bolts to secure the lightbar to the vehicle.

NOTE: Model MKAJ is an adjustable mounting foot. On this model you may loosen the screws on the rear of the foot and adjust the angle of the lightbar. This feature can be used if the angle of the roof is not level with the road.

IMPORTANT: To adjust the leveling screws you must use a torque wrench set at 35 to 40 ft. lbs.

Standard Mounting Foot / Model MKEZ

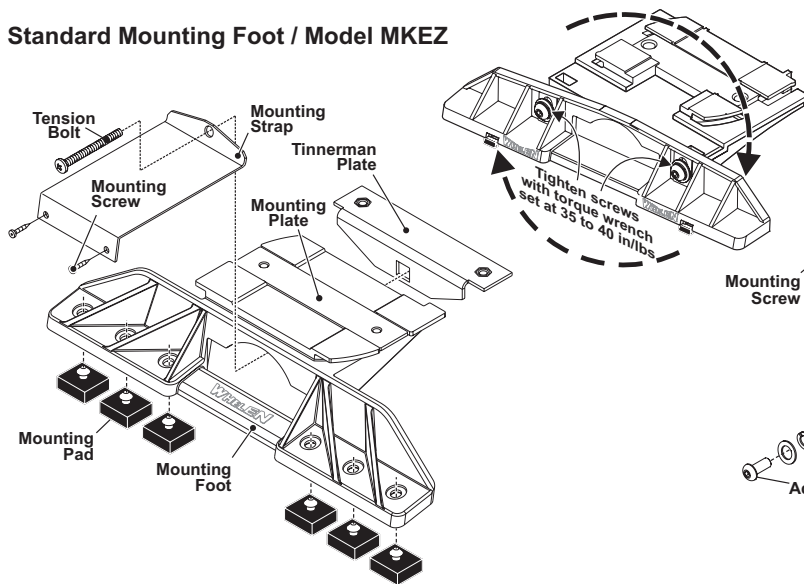

Adjustable Mounting Foot / Model MKAJ

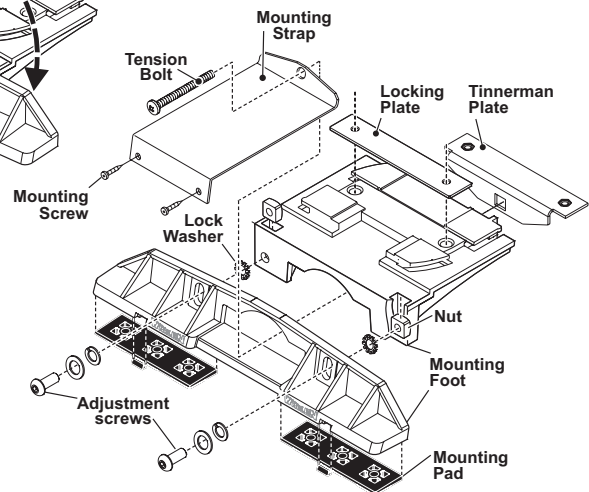

5" Mounting Foot

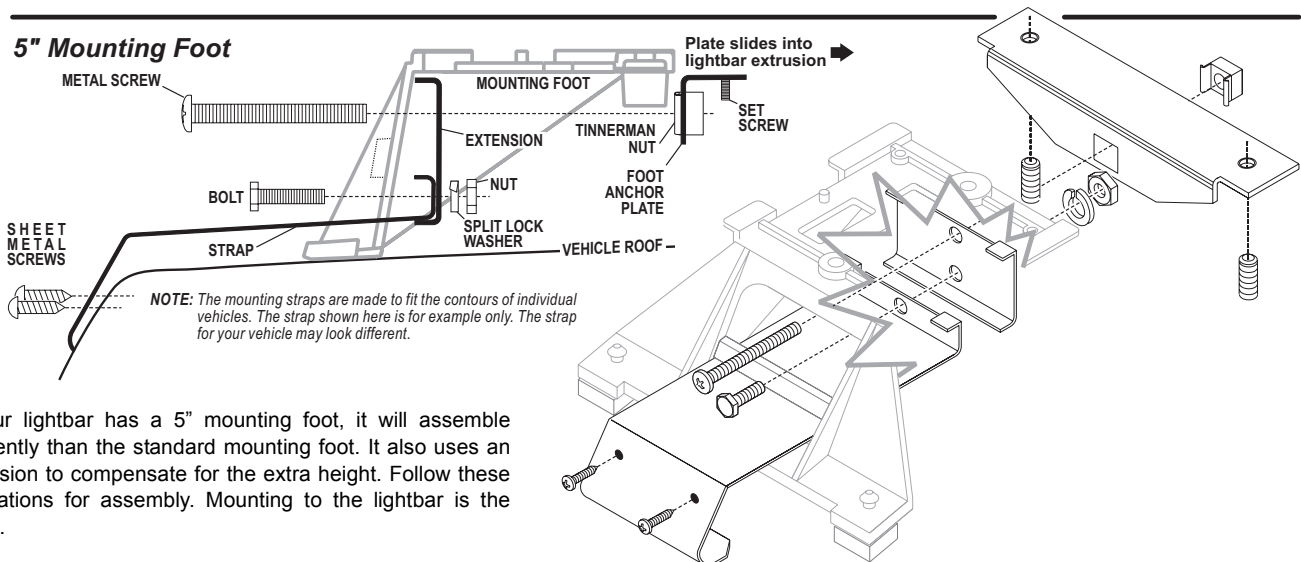

If your lightbar has a 5" mounting foot, it will assemble differently than the standard mounting foot. It also uses an extension to compensate for the extra height. Follow these illustrations for assembly. Mounting to the lightbar is the same.

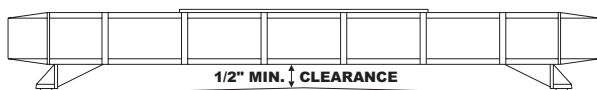

NOTE: Unless otherwise specified, the lightbar mounting feet must be sitting as close to the edge of the roof as possible. They must also be in full contact with the roof and not be hanging off the edge.

IMPORTANT: For strap mounted bars, be sure you have the right sized lightbar for your vehicle. The lightbar should be approximately the same width as the vehicle roof. If too large or small it will not mount properly to the vehicle and may come loose during driving.

IMPORTANT! It is the responsibility of the installation technician to make sure that the installation and operation of this product will not interfere with or compromise the operation or efficiency of any vehicle equipment!

Routing your Lightbar Cable(s):

1. To protect the headliner from damage caused by drilling the cable access hole through the vehicle roof, allow a 5" to 7" distance between roof and headliner by lowering the headliner before drilling.
2. Using a 1" hole saw, drill the cable access hole.

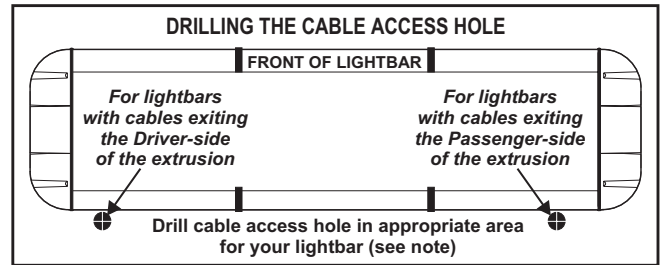

NOTE: There may be a roof support member that spans the distance between the driver's and passenger's side. DO NOT DRILL THROUGH THIS MEMBER! Adjust the location until the hole can be drilled without contacting this support member.

3. Use a round file to smooth and de-burr the edges of the hole.
4. Install a 1" grommet (user supplied) into the cable access hole.
5. Insert the cable(s) through the cable access hole into the vehicle. Use RTV silicone to weatherproof the access hole after the cable(s) are pulled completely into the vehicle.

Route the cable(s) one at a time to their respective destinations (power cable to vehicle battery; control cable to customer switch panel). It is left to the installation technician's discretion to select a path for these cables that will both protect the cables from possible damage and not interfere with the operation of any other vehicle components or equipment. Refer to the instructions included with your switches for switch wiring information.

IMPORTANT AIR BAG WARNING! Do not install this product or route any wires in the air bag deployment zone of your vehicle. Equipment mounted or located in air bag deployment zones will damage or reduce the effectiveness of the air bag, or become a projectile that could cause serious personal injury or death. Refer to your vehicle owners manual to learn the air bag deployment zones for the vehicle. The User/Installer assumes full responsibility to determine proper mounting location, based on providing ultimate safety to all passengers inside the vehicle.

Connecting the Power Cable . . .

WARNING! All customer supplied wires that connect to the positive terminal of the battery must be sized to supply at least 125% of the maximum operating current and FUSED at the battery to carry that load. DO NOT USE CIRCUIT BREAKERS WITH THIS PRODUCT!

1. Follow the factory wiring harness through the firewall. It may be necessary to drill a hole in the firewall. If so, be absolutely sure that there are no components that could be damaged by drilling. After the hole has been drilled, insert a grommet to protect the cable.
2. Route the cable along the factory wiring harness towards the battery. Install a 40 amp fuse block (customer supplied) on the end of the RED wire in the power cable. **NOTE: Remove the fuse from the fuse block before connecting any wires to the battery.**
3. Connect the BLACK wire to Chassis Ground.

Connecting the Communication Cable . . .

Splice the GREEN and GREY wires from the lightbar to the GREEN and GREY wires from the Whelen WC Controller.

Troubleshooting:

Your lightbar should now be fully operational. If it is not functioning properly, check your connections for the following:

- The positive wire (RED) is properly connected to the battery, by way of the user supplied fuse block.
- A working fuse of the correct amperage is installed in the fuse block (See illustration above, for the specific fuse rating for your lightbar).
- The ground wire (BLACK) is properly connected to the factory ground. Be sure that the wire is fully grounded to this location.
- The two communication wires (GREEN and GREY) are properly connected to their communication designations.

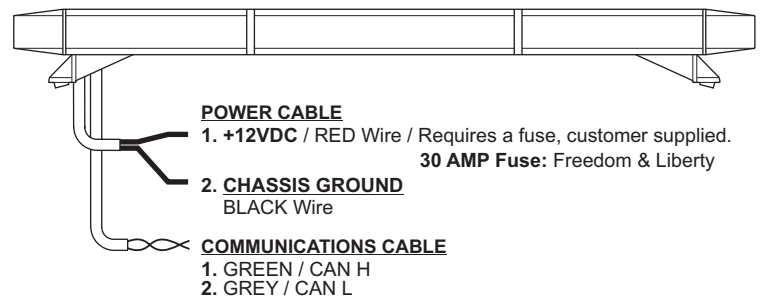

If all of these connections are good, contact your Whelen representative for further assistance.

Freedom Lightbar: Servicing your Lightbar

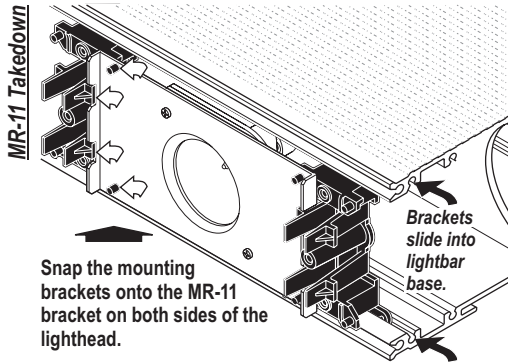

MR-11 Alley Light

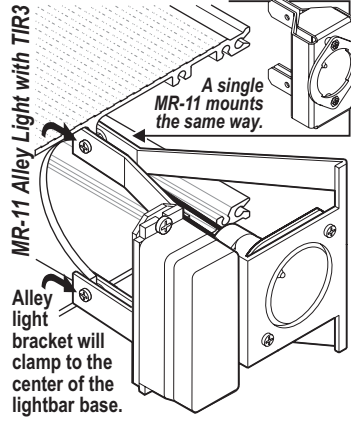

Liberty Lightbar: Servicing your Lightbar

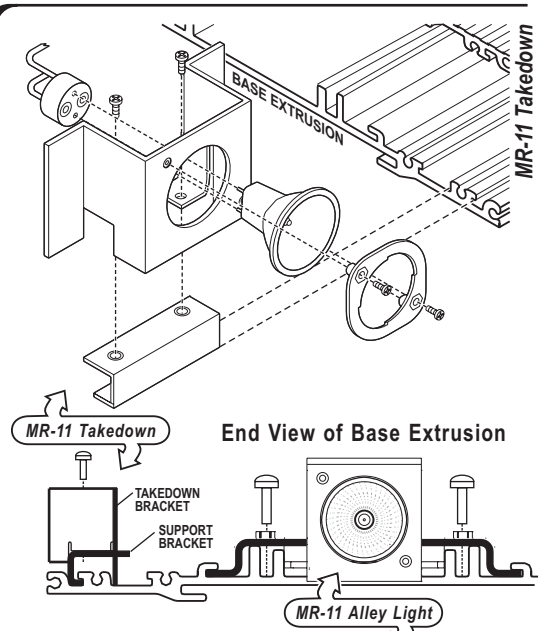

Gasket & Halogen Alley Light

Align lighthouse reflector up with the 4 bosses in the endcap and press reflector into place. The 4 barbs in the endcap should engage around the lighthouse body.

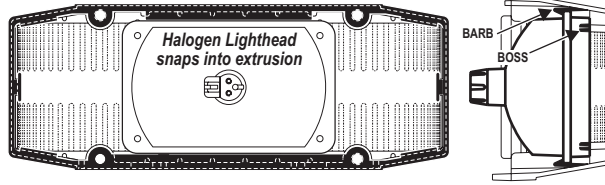

Endcap, Gasket, Lenses & Spacers

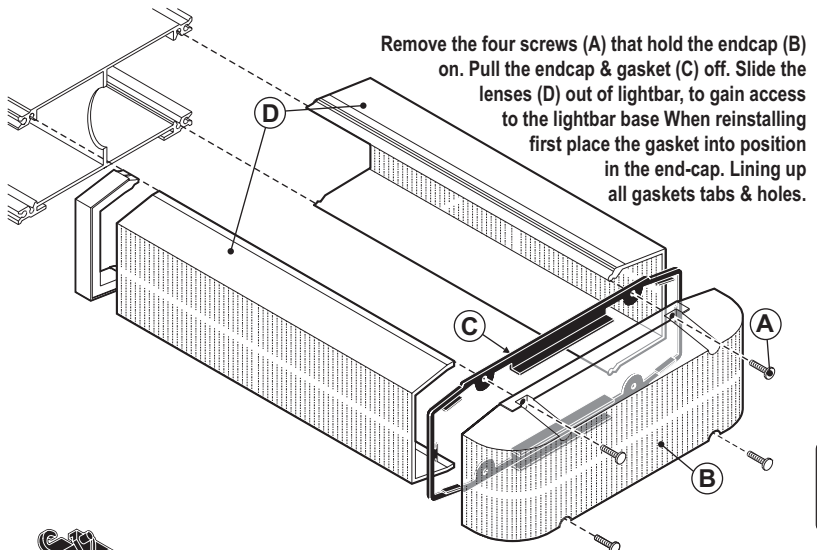

Lighthouse to Extrusion with Brackets

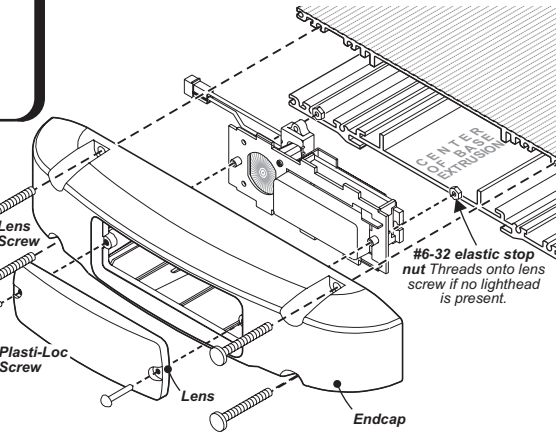
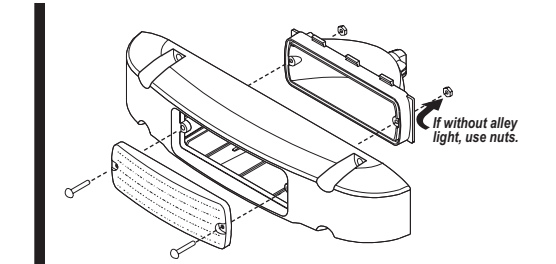
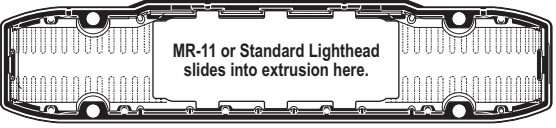
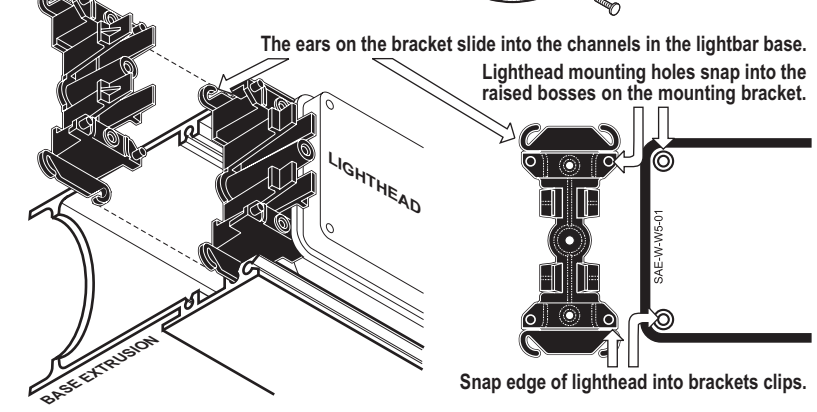

SIDE VIEW OF BASE EXTRUSION

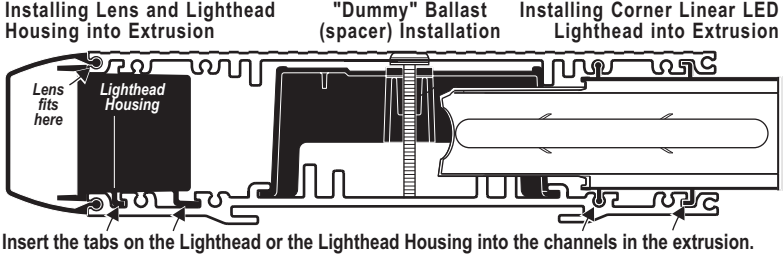

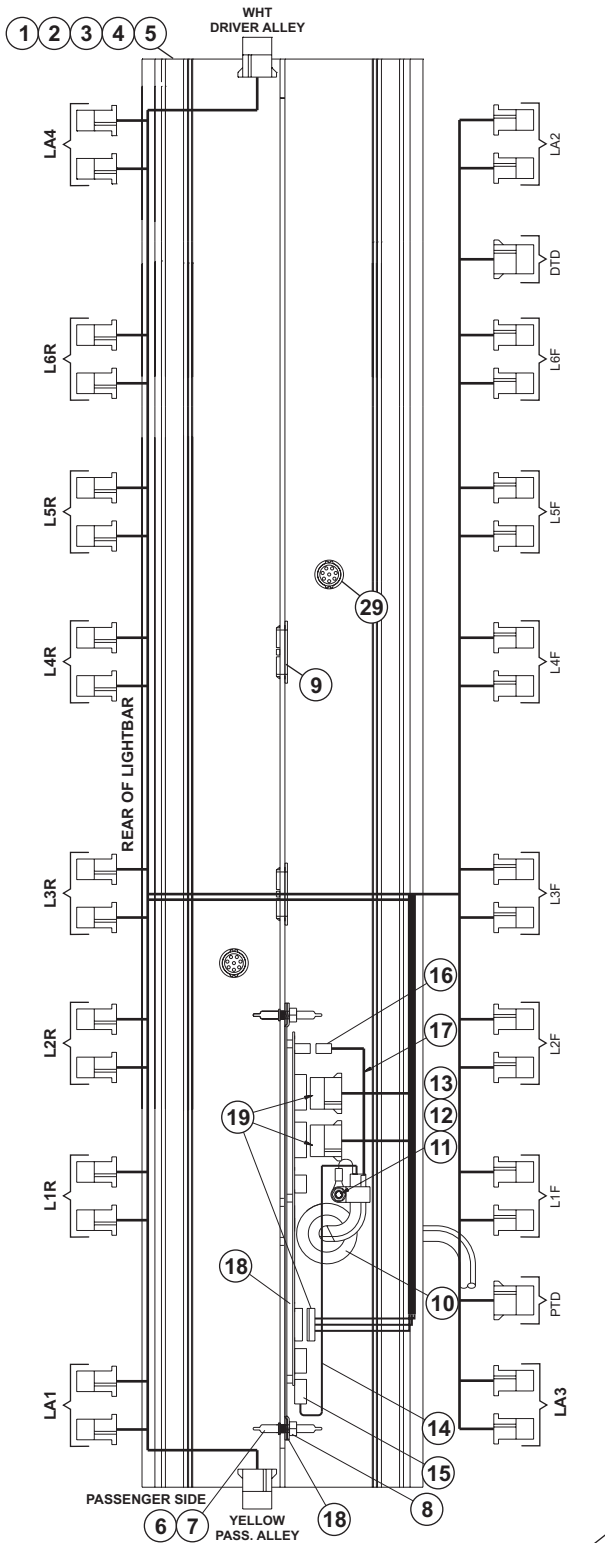

QTY.	QTY.	QTY.	QTY.	ITEM	PART NUMBER	DESCRIPTION
		*	*		01-0684668-	ASS'Y FREEDOM WECAN R/R/B/B 50"
		*	*		01-0684668-	ASS'Y FREEDOM WECAN R/R/B/B 55"
	*				01-0684668-	ASS'Y FREEDOM WECAN R/R/B/B 60"
*					01-0684668-	ASS'Y FREEDOM WECAN R/R/B/B 44"
1	-	-	-	1	11-363390-000	BASE EXTRUSION (40.375")
-	-	-	1	2	11-363141-000	BASE EXTRUSION (45.75")
-	-	1	-	3	11-363142-000	BASE EXTRUSION (51.125")
-	1	-	-	4	11-363143-000	BASE EXTRUSION (56.50")
1	1	1	1	5	10-0523067-02	LABEL, MODEL & SERIAL NO.
2	2	2	2	6	22-0542701-00	MTG. STUD
4	4	4	4	7	22-0416982-00	PROTECTIVE COVER
2	2	2	2	8	13-130111-072	NUT, 1/4-20 ELASTIC STOP (316 STAINLESS)
2	2	2	2	9	21-242401-000	BUSHING, 1-5/8"
1	1	1	1	10	21-11245004-1	GROMMET, 1.562"
1	1	1	1	11	14-104216-160	#10-24 x 1 PPHMS
1	1	1	1	12	13-104111-063	NUT, #10-24 WHIZ
1	1	1	1	13	26-0115037-08	CABLE CLAMP, 1/2"
1	1	1	1	14	46-0743423-17	CABLE, 2/C 10GA (17")
1	1	1	1	15	39-0917403-02	HOUSING, PWR/GND
1	1	1	1	16	39-0403023-04	HOUSING, 3 POS SOCKET
1	1	1	1	17	46-0743442-00	CABLE, 2/C 22GA 17"
1	1	1	1	18	01-0264939-00	ASS'Y, POWER/COMMUNICATIONS "WC"
1	1	1	1	19	46-0985997-00	HARNES, INTERNAL FREEDOM "WC"
-	-	-	-	20	01-0264564110	CORNER REFLECTOR LED AMBER
2	2	2	2	21	01-0264564220	CORNER REFLECTOR LED BLUE
-	-	-	-	22	01-0264564330	CORNER REFLECTOR LED WHITE
-	-	-	-	23	01-0264564440	CORNER REFLECTOR LED GREEN
2	2	2	2	24	01-0264564550	CORNER REFLECTOR LED RED
12	18	18	14	25	07-263103-000	MOUNTING BRACKET
10	16	12	12	26	09-1363158-00	FILLER PANEL, "400" SERIES
1	1	1	1	27	10-0322935-00	LABEL, "FRONT"
A/R	A/R	A/R	A/R	28	02-0364584-00	MR11 ALLEY LIGHT ASSEMBLY
2	2	2	2	29	21-7263998-00	VENT, 3/4"
2	-	-	-	30	68-1983816-30	LENS, 5.00" CLEAR
4	4	-	4	31	68-1983817-30	LENS, 6.562" CLEAR
-	-	4	-	32	68-1984104-30	LENS, 9.25" CLEAR
-	-	4	-	33	07-242815-000	BRACKET, SPACER
2	2	2	2	34	38-0283381-00	GASKET, ENDCAP
2	2	2	2	35	68-1183369-30	ENDCAP, CLEAR
8	8	8	8	36	14-104286-16JB	#10-24 x 1-1/4" TX. PHD. SCREW W/SHOULDER
8	8	6	6	37	02-0341448-30	LENS DIVIDER ASS'Y. (CLEAR)
-	4	4	4	38	68-1984105-30	LENS, 15.75" CLEAR
4	2	-	-	39	68-1183491C02	LENS, 10.375" CLEAR
A/R	A/R	A/R	A/R	40	02-0364528211	LINEAR LED 400 AMBER GEN III AMP
A/R	A/R	A/R	A/R	41	02-0364528222	LINEAR LED 400 BLUE GEN III AMP
A/R	A/R	A/R	A/R	42	02-0364528233	LINEAR LED 400 WHITE GEN III AMP
A/R	A/R	A/R	A/R	43	02-0364528244	LINEAR LED 400 GREEN GEN III AMP
A/R	A/R	A/R	A/R	44	02-0364528255	LINEAR LED 400 RED GEN III AMP

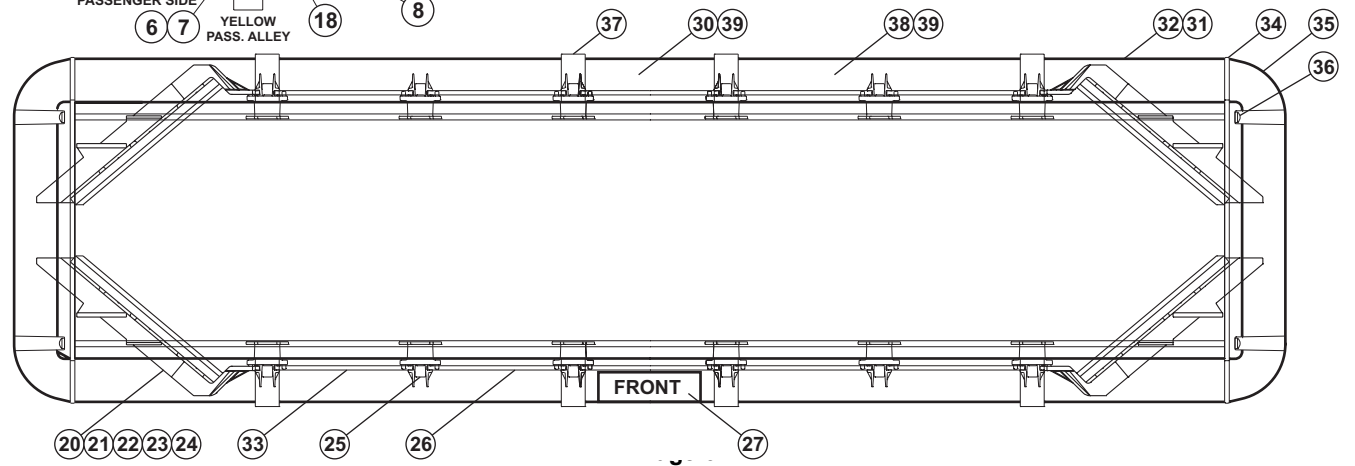
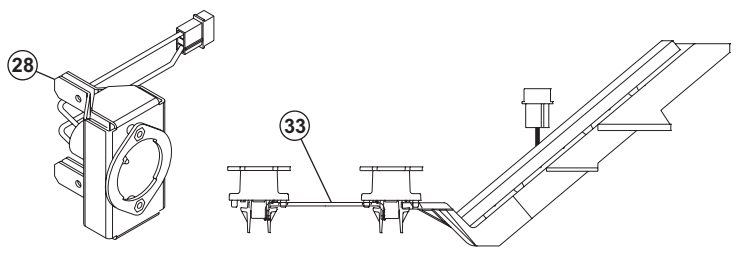

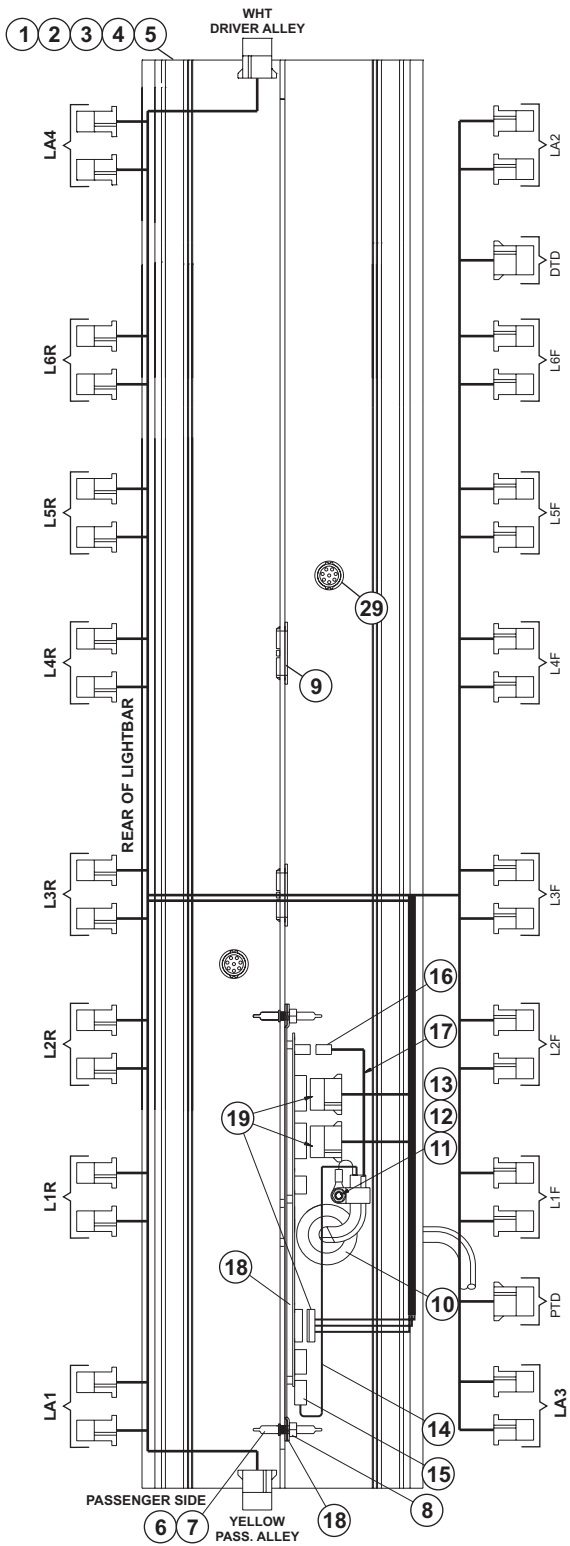

QTY.	QTY.	QTY.	QTY.	ITEM	PART NUMBER	DESCRIPTION
			*		01-0684668-	ASS'Y FREEDOM WECAN R/R/B/B 50"
			*		01-0684668-	ASS'Y FREEDOM WECAN R/R/B/B 55"
			*		01-0684668-	ASS'Y FREEDOM WECAN R/R/B/B 60"
			*		01-0684668-	ASS'Y FREEDOM WECAN R/R/B/B 44"
1	-	-	-	1	11-363390-000	BASE EXTRUSION (40.375")
-	-	-	-	2	11-363141-000	BASE EXTRUSION (45.75")
-	-	1	-	3	11-363142-000	BASE EXTRUSION (51.125")
-	1	-	-	4	11-363143-000	BASE EXTRUSION (56.50")
1	1	1	1	5	10-0523067-02	LABEL, MODEL & SERIAL NO.
2	2	2	2	6	22-0542701-00	MTG. STUD
4	4	4	4	7	22-0416982-00	PROTECTIVE COVER
2	2	2	2	8	13-130111-072	NUT, 1/4-20 ELASTIC STOP (316 STAINLESS)
2	2	2	2	9	21-242401-000	BUSHING, 1-5/8"
1	1	1	1	10	21-11245004-1	GROMMET, 1.562"
1	1	1	1	11	14-104216-160	#10-24 x 1 PPHMS
1	1	1	1	12	13-104111-063	NUT, #10-24 WHIZ
1	1	1	1	13	26-0115037-08	CABLE CLAMP, 1/2"
1	1	1	1	14	46-0743423-17	CABLE, 2/C 10GA (17")
1	1	1	1	15	39-0917403-02	HOUSING, PWR/GND
1	1	1	1	16	39-0403023-04	HOUSING, 3 POS SOCKET
1	1	1	1	17	46-0743442-00	CABLE, 2/C 22GA 17"
1	1	1	1	18	01-0264939-00	ASS'Y, POWER/COMMUNICATIONS "WC"
1	1	1	1	19	46-0985997-00	HARNES, INTERNAL FREEDOM "WC"
-	-	-	-	20	01-0264564110	CORNER REFLECTOR LED AMBER
2	2	2	2	21	01-0264564220	CORNER REFLECTOR LED BLUE
-	-	-	-	22	01-0264564330	CORNER REFLECTOR LED WHITE
-	-	-	-	23	01-0264564440	CORNER REFLECTOR LED GREEN
2	2	2	2	24	01-0264564550	CORNER REFLECTOR LED RED
12	18	18	14	25	07-263103-000	MOUNTING BRACKET
10	16	12	12	26	09-1363158-00	FILLER PANEL, "400" SERIES
1	1	1	1	27	10-0322935-00	LABEL, "FRONT"
A/R	A/R	A/R	A/R	28	02-0364584-00	MR11 ALLEY LIGHT ASSEMBLY
2	2	2	2	29	21-7263998-00	VENT, 3/4"
2	-	-	-	30	68-1983816-30	LENS, 5.00" CLEAR
4	4	-	4	31	68-1983817-30	LENS, 6.562" CLEAR
-	-	4	-	32	68-1984104-30	LENS, 9.25" CLEAR
-	-	4	-	33	07-242815-000	BRACKET, SPACER
2	2	2	2	34	38-0283381-00	GASKET, ENDCAP
2	2	2	2	35	68-1183369-30	ENDCAP, CLEAR
8	8	8	8	36	14-104286-16JB	#10-24 x 1-1/4" TX. PHD. SCREW W/SHOULDER
8	8	6	6	37	02-0341448-30	LENS DIVIDER ASS'Y. (CLEAR)
-	4	4	4	38	68-1984105-30	LENS, 15.75" CLEAR
4	2	-	-	39	68-1183491C02	LENS, 10.375" CLEAR
A/R	A/R	A/R	A/R	40	02-0364528211	LINEAR LED 400 AMBER GEN III AMP
A/R	A/R	A/R	A/R	41	02-0364528222	LINEAR LED 400 BLUE GEN III AMP
A/R	A/R	A/R	A/R	42	02-0364528233	LINEAR LED 400 WHITE GEN III AMP
A/R	A/R	A/R	A/R	43	02-0364528244	LINEAR LED 400 GREEN GEN III AMP
A/R	A/R	A/R	A/R	44	02-0364528255	LINEAR LED 400 RED GEN III AMP
4	4	4	4	45	20-0042765-00	SPACER CORNER STROBE

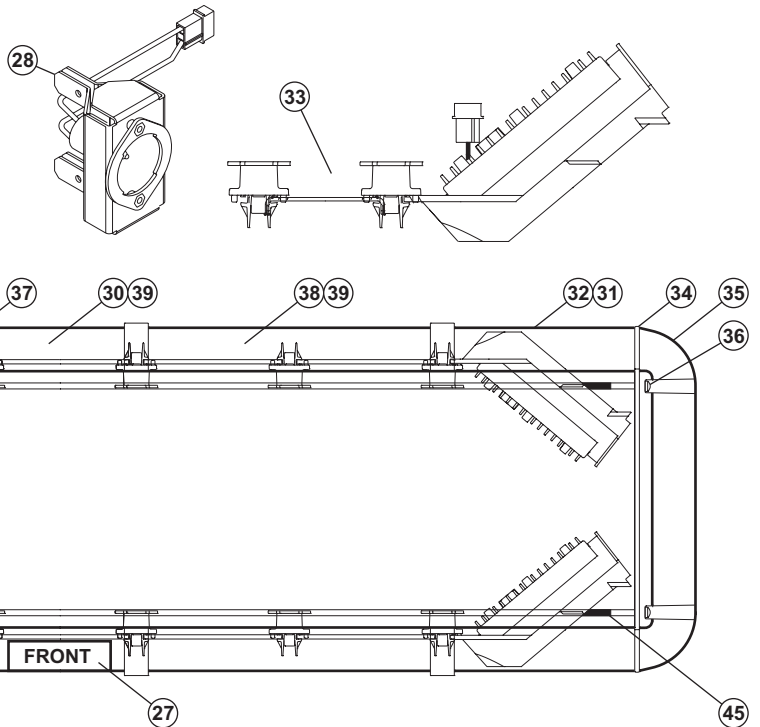

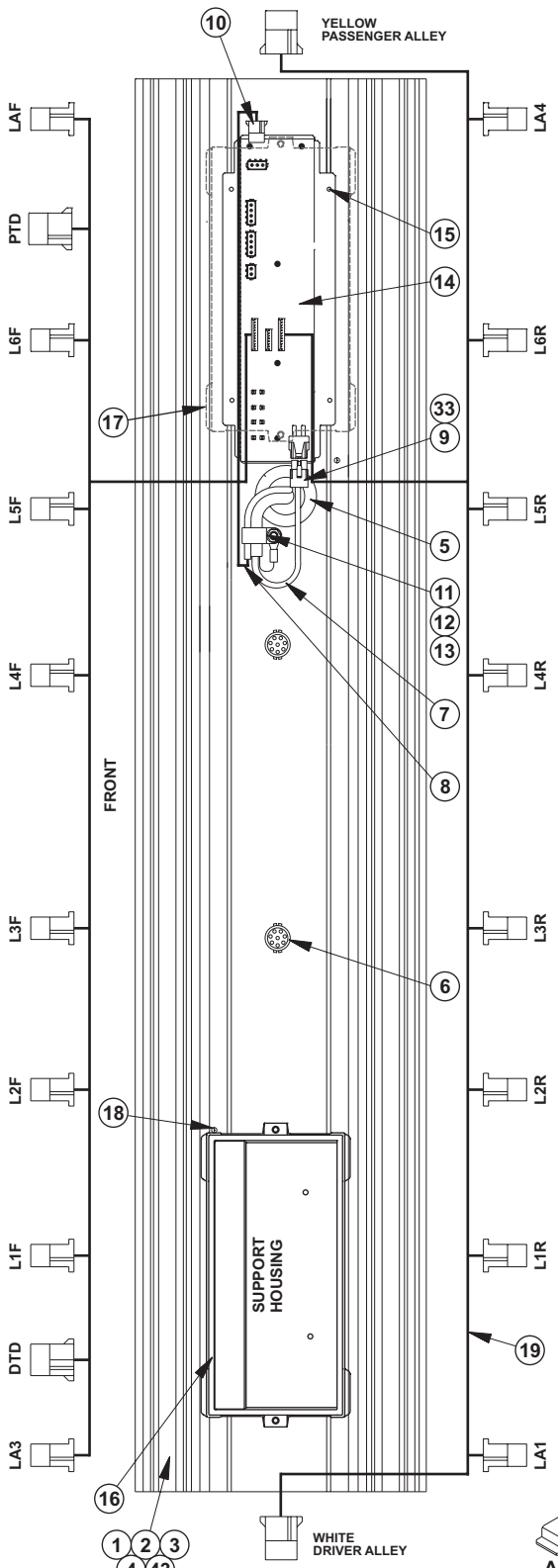

QTY.	QTY.	QTY.	QTY.	ITEM	PART NUMBER	DESCRIPTION
		*			01-0684682-	ASS'Y, LIBERTY 43" WECAN LIGHTBAR
		*			01-0684682-	ASS'Y, LIBERTY 48" WECAN LIGHTBAR
	*				01-0684682-	ASS'Y, LIBERTY 54" WECAN LIGHTBAR
*					01-0684682-	ASS'Y, LIBERTY 60" WECAN LIGHTBAR
-	-	-	1	1	11-363312-038	BASE, EXTRUDED (38.61")
-	-	1	-	2	11-363312-044	BASE, EXTRUDED (44.00")
-	1	-	-	3	11-363312-049	BASE, EXTRUDED (49.39")
1	-	-	-	4	11-363312-054	BASE, EXTRUDED (54.78")
1	1	1	1	5	21-11245004-1	GROMMET, 1.562
2	2	2	2	6	21-7263998-00	PLUG, VENT (3/4")
1	1	1	1	7	46-0743196-17	CABLE, 2/C 10GA (17")
1	1	1	1	8	46-0743442-00	CABLE, 2/C 22GA (17")
1	1	1	1	9	39-0917403-02	HOUSING, PWR/GND
1	1	1	1	10	39-0403023-04	HOUSING, 3 POS SOCKET
1	1	1	1	11	14-104216-160	#10-24 x 1 PPHM SCREW
1	1	1	1	12	13-104111-063	#10-24 WIZ NUT
1	1	1	1	13	26-0115037-08	CABLE CLAMP 1/2"
1	1	1	1	14	01-0264940-00	ASSEMBLY, POWER/COMMUNICATIONS "WC"
2	2	2	2	15	14-0050503-30	SCREW,#6-32 x 1/2"
1	1	1	1	16	11-483569-000	HOUSING, SUPPORT HOUSING
1	1	1	1	17	11-484685-000	HOUSING, SUPPORT HOUSING SNAP IN
2	2	2	2	18	14-104216-06J	#10-24 x 3/8 PPH SCREW
1	1	1	1	19	46-0985994-00	HARNES, LIBERTY "WC" LIGHTBAR
16	12	12	10	20	11-483564-000	HOUSING, LIGHTHEAD (SNAP IN)
A/R	A/R	A/R	A/R	21	01-0264484210	EXTENDED, CORNER 12 L.E.D. AMBER
A/R	A/R	A/R	A/R	22	01-0264484220	EXTENDED, CORNER 12 L.E.D. BLUE
A/R	A/R	A/R	A/R	23	01-0264484230	EXTENDED, CORNER 12 L.E.D. WHITE
A/R	A/R	A/R	A/R	24	01-0264484250	EXTENDED, CORNER 12 L.E.D. RED
A/R	A/R	A/R	A/R	25	01-0264484240	EXTENDED, CORNER 12 L.E.D. GREEN
16	12	12	10	26	09-1363542-00	PANEL, FILLER (500 SERIES)
A/R	A/R	A/R	A/R	27	01-0264077210	SUB ASS'Y, 500 LED, AMBER, 2 POS AMP
A/R	A/R	A/R	A/R	28	01-0264077220	SUB ASS'Y, 500 LED, BLUE, 2 POS AMP
A/R	A/R	A/R	A/R	29	01-0264077230	SUB ASS'Y, 500 LED, WHITE, 2 POS AMP
A/R	A/R	A/R	A/R	30	01-0264077250	SUB ASS'Y, 500 LED, RED, 2 POS AMP
A/R	A/R	A/R	A/R	31	01-0264077240	SUB ASS'Y, 500 LED, GREEN, 2 POS AMP
-	4	-	-	32	07-243170-000	SPACER, CORNER
1	1	1	1	33	14-062216-160	#6-32 x 1 PPHSMS
-	-	-	1	34	11-263313-038	EXTRUSION, TOP 38.61" W/HOLES
-	-	1	-	35	11-263313-044	EXTRUSION, TOP 44.00" W/HOLES
-	1	-	-	36	11-263313-049	EXTRUSION, TOP 49.39" W/HOLES
1	-	-	-	37	11-263313-054	EXTRUSION, TOP 54.78" W/HOLES
4	4	4	4	38	15-105A76-168	#10 x 1" TX. 100 FH PLASTI-LOC, W/SEAL
2	2	2	2	39	38-0283572-00	GASKET, ENDCAP
8	6	6	8	40	02-0342791-30	ASS'Y, LENS DIVIDER (CLEAR)
2	2	2	2	41	68-1183566-3S	LENS, ENDCAP (CLEAR) W/SEAL
8	8	8	8	42	14-104286-16J	#10-24 x 1-1/4" TX. PHD W/SHOULDER
1	1	1	1	43	10-0522960-00	LABEL, MODEL & SERIAL NO.
-	-	-	2	44	68-1983818-30	LENS, 5.062" LG (CLEAR)
4	-	4	4	45	68-1983819-30	LENS, 5.687" LG (CLEAR)
-	4	-	-	46	68-1963333C08	LENS, 8.375" LG (CLEAR)
2	-	-	4	47	68-1963333C03	LENS, 10.500" LG (CLEAR)
4	4	4	-	48	68-1983567-30	LENS, 15.800" LG (CLEAR)
2	2	2	2	49	68-3963228-30	LENS, 500 SERIES, NON OPTIC (CLEAR)
4	4	4	4	50	14-062216-100	#6-32 x 5/8" PPHMS
4	4	4	4	51	13-062120-052	#6-32 ELASTIC STOP NUT
A/R	A/R	A/R	A/R	52	02-0364429-00	SUB ASS'Y, MR-11 ALLEY LIGHT

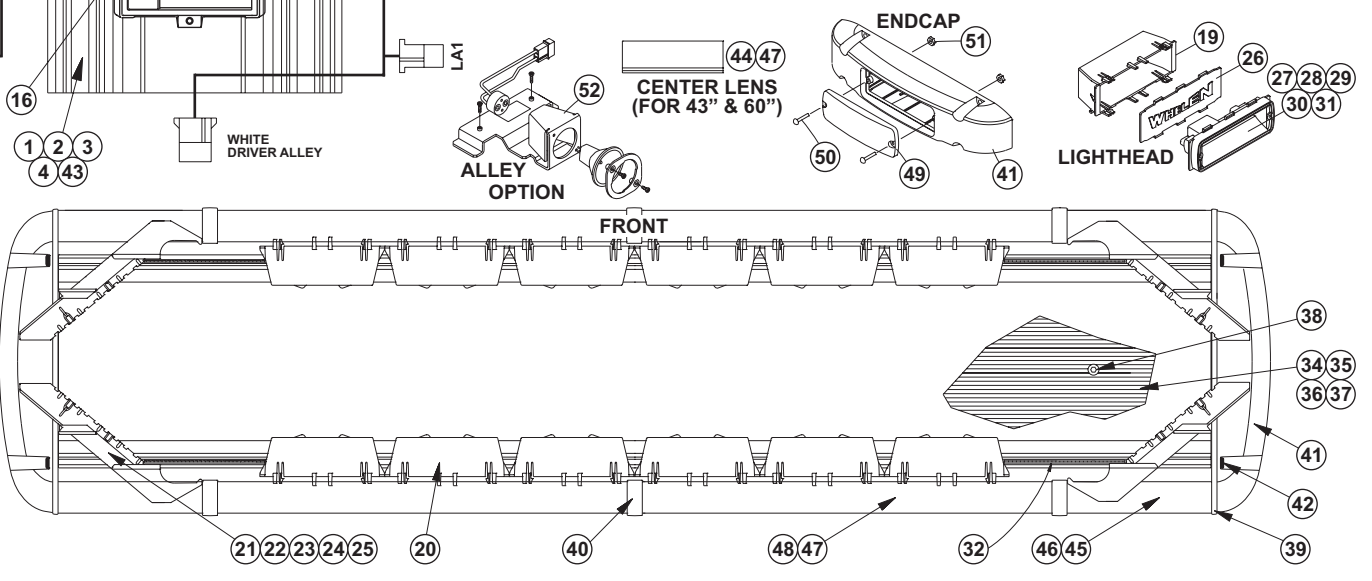

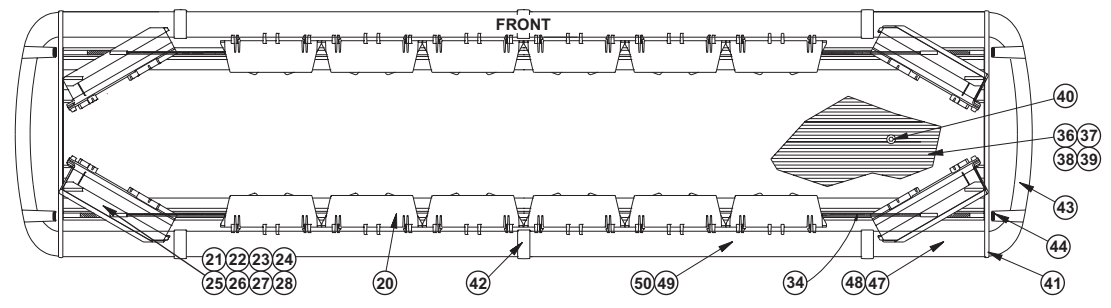
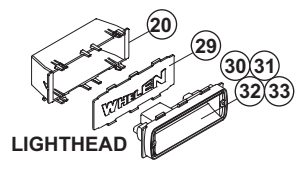
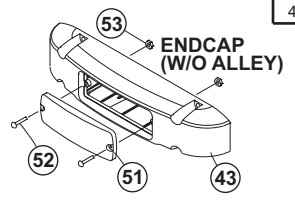
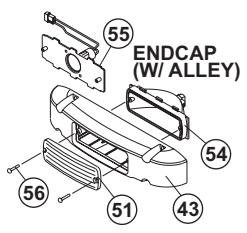
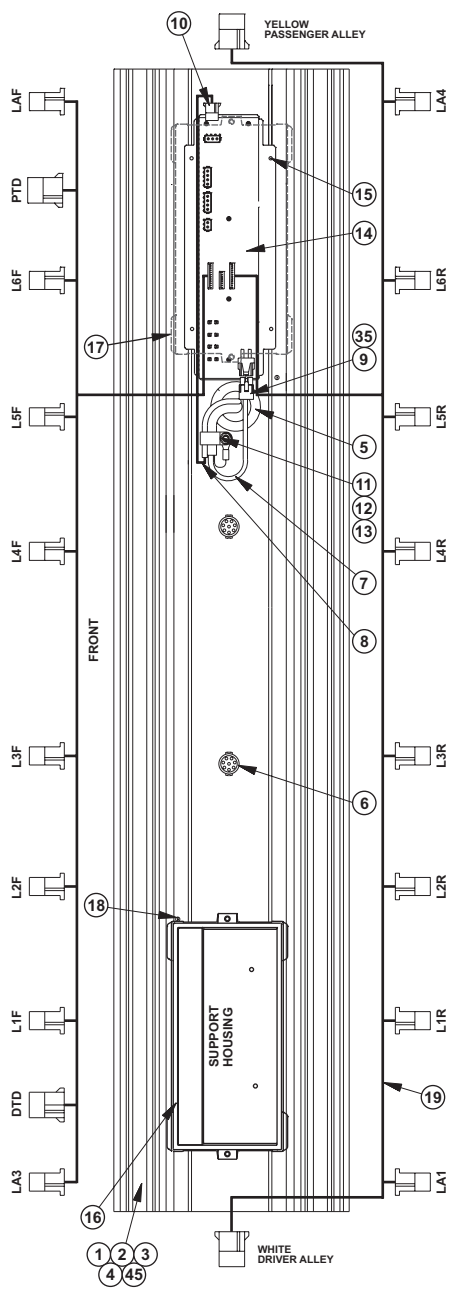

QTY.	QTY.	QTY.	QTY.	ITEM	PART NUMBER	DESCRIPTION
		*			01-0684682-	ASS'Y, LIBERTY 43" WECAN LIGHTBAR
		*			01-0684682-	ASS'Y, LIBERTY 48" WECAN LIGHTBAR
	*				01-0684682-	ASS'Y, LIBERTY 54" WECAN LIGHTBAR
*					01-0684682-	ASS'Y, LIBERTY 60" WECAN LIGHTBAR
-	-	-	1	1	11-363312-038	BASE, EXTRUDED (38.61")
-	-	1	-	2	11-363312-044	BASE, EXTRUDED (44.00")
-	1	1	-	3	11-363312-049	BASE, EXTRUDED (49.39")
1	-	-	-	4	11-363312-054	BASE, EXTRUDED (54.78")
1	1	1	1	5	21-11245004-1	GROMMET, 1.562
2	2	2	2	6	21-7263998-00	PLUG, VENT (3/4")
1	1	1	1	7	46-0743196-17	CABLE, 2/C 10GA (17")
1	1	1	1	8	46-0743442-00	CABLE, 2/C 22GA (17")
1	1	1	1	9	39-0917403-02	HOUSING, PWR/GND
1	1	1	1	10	39-0403023-04	HOUSING, 3 POS SOCKET
1	1	1	1	11	14-104216-160	#10-24 x 1 PPHM SCREW
1	1	1	1	12	13-104111-063	#10-24 WIZ NUT
1	1	1	1	13	26-0115037-08	CABLE CLAMP 1/2"
1	1	1	1	14	01-0264940-00	ASSEMBLY, POWER/COMMUNICATIONS "WC"
2	2	2	2	15	14-0050503-30	SCREW,#6-32 x 1/2"
1	1	1	1	16	11-483569-000	HOUSING, SUPPORT HOUSING
1	1	1	1	17	11-484685-000	HOUSING, SUPPORT HOUSING SNAP IN
2	2	2	2	18	14-104216-06J	#10-24 x 3/8 PPH SCREW
1	1	1	1	19	46-0985994-00	HARNESS, LIBERTY "WC" LIGHTBAR
16	12	12	10	20	11-483564-000	HOUSING, LIGHTHEAD (SNAP IN)
A/R	A/R	A/R	A/R	21	01-0263927210	CORNER 12 L.E.D. AMBER, LIBERTY
A/R	A/R	A/R	A/R	22	01-0263927220	CORNER 12 L.E.D. BLUE, LIBERTY
A/R	A/R	A/R	A/R	23	01-0263927230	CORNER 12 L.E.D. WHITE, LIBERTY
A/R	A/R	A/R	A/R	24	01-0263927250	CORNER 12 L.E.D. RED, LIBERTY
A/R	A/R	A/R	A/R	25	01-0263927910	CORNER 9 L.E.D. AMBER, LIBERTY
A/R	A/R	A/R	A/R	26	01-0263927920	CORNER 9 L.E.D. BLUE, LIBERTY
A/R	A/R	A/R	A/R	27	01-0263927930	CORNER 9 L.E.D. WHITE, LIBERTY
A/R	A/R	A/R	A/R	28	01-0263927950	CORNER 9 L.E.D. RED, LIBERTY
16	12	12	10	29	09-1363542-00	PANEL, FILLER (500 SERIES)
A/R	A/R	A/R	A/R	30	01-0264077210	SUB ASS'Y, 500 LED, AMBER, 2 POS AMP
A/R	A/R	A/R	A/R	31	01-0264077220	SUB ASS'Y, 500 LED, BLUE, 2 POS AMP
A/R	A/R	A/R	A/R	32	01-0264077230	SUB ASS'Y, 500 LED, WHITE, 2 POS AMP
A/R	A/R	A/R	A/R	33	01-0264077250	SUB ASS'Y, 500 LED, RED, 2 POS AMP
-	4	-	-	34	07-243170-000	SPACER, CORNER
1	1	1	1	35	14-062216-160	#6-32 x 1 PPHMS
-	-	-	1	36	11-263313-038	EXTRUSION, TOP 38.61" W/HOLES
-	-	1	-	37	11-263313-044	EXTRUSION, TOP 44.00" W/HOLES
-	1	-	-	38	11-263313-049	EXTRUSION, TOP 49.39" W/HOLES
1	-	-	-	39	11-263313-054	EXTRUSION, TOP 54.78" W/HOLES
4	4	4	4	40	15-105A76-168	#10 x 1" TX. 100 FH PLASTI-LOC, W/SEAL
2	2	2	2	41	38-0283572-00	GASKET, ENDCAP
8	6	6	8	42	02-0342791-30	ASS'Y, LENS DIVIDER (CLEAR)
2	2	2	2	43	68-1183566-3S	LENS, ENDCAP (CLEAR) W/SEAL
8	8	8	8	44	14-104286-16J	#10-24 x 1-1/4" TX. PHD W/SHOULDER
1	1	1	1	45	10-0522960-00	LABEL, MODEL & SERIAL NO.
-	-	-	2	46	68-1983818-30	LENS, 5.062" LG (CLEAR)
4	-	4	4	47	68-1983819-30	LENS, 5.687" LG (CLEAR)
-	4	-	-	48	68-1963333C08	LENS, 8.375" LG (CLEAR)
2	-	-	4	49	68-1963333C03	LENS, 10.500" LG (CLEAR)
4	4	4	-	50	68-1983567-30	LENS, 15.800" LG (CLEAR)
2	2	2	2	51	68-3963228-30	LENS, 500 SERIES, NON OPTIC (CLEAR)
4	4	4	4	52	14-062216-100	#6-32 x 5/8" PPHMS
4	4	4	4	53	13-062120-052	#6-32 ELASTIC STOP NUT
A/R	A/R	A/R	A/R	54	02-0383577-03	SUB ASS'Y, 500 HALOGEN W/3 POS
A/R	A/R	A/R	A/R	55	02-0363847-01	SUB ASS'Y, MR-11 ALLEY LIGHT
A/R	A/R	A/R	A/R	56	15-065410-100	#6 x 5/8" PPH PLASTI-LOC SS
4	4	4	4	57	20-0042765-00	SPACER, CORNER RETENTION